

Auchenflower station accessibility upgrade

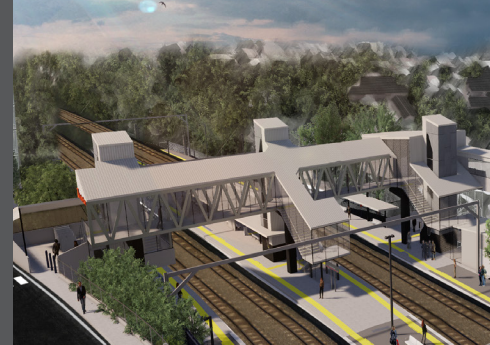

WORKS NOTICE

Night works and lane closure January 2021

As part of the Auchenflower station accessibility upgrade, Queensland Rail will undertake night works **between 6.30pm and 6.30am on selected nights in January 2021** (weather and construction conditions permitting).

For safety, these works can only be undertaken at night when there is reduced rail traffic.

Residents near the station may experience some noise associated with construction activity, the operation of machinery and the movement of vehicles and equipment around the work zone.

During works, the station concourse will be open to pedestrian traffic.

Every effort will be made to minimise disruption and we apologise for any inconvenience as we build you a better Auchenflower station.

Overview of night works

Location	Dates and hours of work	Type of work
Lang Parade - lane closure	6.30pm to 6.30am the next day on: <ul style="list-style-type: none">Sunday 10 January	Site establishment works involving: <ul style="list-style-type: none">traffic management - Lang Parade (near the pedestrian crossing)temporary fencing and barrier installationsexcavation and earthworksoperation of excavators and trucks with flashing lights and reversing beepers
Auchenflower station precinct - between platform 1 and Lang Parade	6.30pm to 6.30am the next day on: <ul style="list-style-type: none">Tuesday 12 and Wednesday 13 January (over two nights)	<ul style="list-style-type: none">use of hand-held tools and powered equipmentmovement of personnel and vehicles around the station and Lang Parade.

The Auchenflower station accessibility upgrade is part of the State Government's ongoing investment of more than \$500 million to upgrade stations across the South East Queensland network, making them more accessible for customers.

For more information, please contact the project's community team on **1800 722 203** (free call) or email stationsupgrade@qr.com.au

Subscribe for updates

We are moving to paperless notifications about noise and works.
Sign up on our website or contact us if you prefer to receive paper copies.

Sign up at queenslandrail.com.au/EmailNotifications

